

ROYAL YACHT CLUB OF VICTORIA



**NEW MEMBER &
VISITOR INFORMATION**

WELCOME

Royal Yacht Club Victoria (RYCV) was initially founded as the Port Phillip Yacht Club in May 1853 and remains to be one of the oldest yacht clubs in Australia. The Club is situated in Williamstown with a stunning view of the city skyline and is steeped in decades of yachting history and tradition.

Today RYCV boasts more than 1,000 Members and over 300 yachts on the register making it an ideal Club for sailors with all levels of experience. Sailors can enjoy reliable and steady breezes with little or no current, making it a perfect stretch of water for club sailing or state, national and international regattas. Royals Training Centre offers courses for all ages and we have a strong and lively social program which is enjoyed by our Members and their guests.

With its warm and friendly atmosphere, packed sailing calendar, expansive hardstand and marina, dedicated training centre, dining room, deck and lawn areas, Royals certainly has something for everyone!



CONTACTS & OPENING HOURS

Royal Yacht Club of Victoria

120 Nelson Place, Williamstown VIC 3016

Ph: 03 9397 1277

rycv@rycv.asn.au

www.rycv.com.au

Staff

Michael Neumann	General Manager	MichaelN@rycv.asn.au
Andy Warner	Sailing Manager	sailmanager@rycv.asn.au
Ian Fox	Training Manager	IanF@rycv.asn.au
Simone Kienc	Food and Beverage Manager	bookings@rycv.asn.au
Melissa Wisbey	Membership and Sailing Administration	club.admin@rycv.asn.au

Flag Officers

Tim Olding	Commodore	Commodore@rycv.asn.au
Damian Purcell	Vice Commodore	vice_commodore@rycv.asn.au
Cath Beaufort	Rear Commodore Sailing	rear_commodore_sailing@rycv.asn.au
Guy Schofield	Rear Commodore Club	rear_commodore_club@rycv.asn.au

Opening Hours

	Bar	Restaurant	Office
Monday	Closed	Closed	9am – 5pm
Tuesday	Closed	Closed	9am – 5pm
Wednesday	12pm – 8pm	12pm – 7pm A la Carte	9am – 5pm
Thursday	Closed	Closed	9am – 5pm
Friday	3pm – 9pm	5pm – 8.30pm	9am – 5pm
Saturday	9am – 9pm	12pm – 3pm, 4pm – 8.30pm	9am – 4pm
Sunday	9am – 6pm	12pm – 4pm	Closed
Public Holidays	As Advertised	As Advertised	Closed

FACILITIES & SERVICES

RYCV has a large marina and hard stand for boat storage and servicing.

Our services include:

- Fixed pile berths
- Fuel
- Slipway
- Trailer parking
- Hard stand
- Kayak storage
- Paddle board storage
- Trailer boat launching
- Towing to and from your berth, and securing in pen
- Travel lift with a 28,000kg capacity
- Standard pressure washing
- Stepping or un-stepping of masts
- Securing vessels in cradles or on blocks
- Vessel and mast storage
- Forklift hire
- Vacuum sanding
- 2 x 3 tonne slewing cranes
- Lockers
- Visitor berthing

In addition, RYCV offers;

- Accredited Training Centre with a range of courses for all ages and abilities
- Comprehensive year round sailing/racing schedule
- Bar and restaurant
- Function spaces
- BBQ area
- Large deck and lawn area with permanent tables
- Regular social activities



BAR & RESTAURANT



BAR AND RESTAURANT

RYCV has multiple dining options with a Members' Bar, formal dining room, large deck and expansive lawn area with picnic tables. We offer both bar snacks and a full seasonal a la carte menu; there is something for everyone.

Come down and enjoy our food and beverage service – and the best views in Melbourne! On Sundays, we often have live music so it's the perfect place to relax.

Bookings are recommended and can be made [here](#)

FUNCTIONS & EVENTS

The warm and friendly atmosphere makes Royals a stunning and unique function venue for all occasions for both Members and non-members alike. With stunning views back to the city, our clubhouse is the perfect location for any event including birthdays, weddings, conferences, engagements, community fundraisers, celebrations of life, baby showers, christenings, Christmas parties and more.

Our spaces include the Committee Room, whole Dining Room, Dining Room Parquetry area only, Dining Room Fireplace, the Deck, Library, Lawn and exclusive use of the whole venue. Our conference packages can cater to many different configurations - u-shape, boardroom, theatre, classroom and the list goes on. We can also cater to

We offer customisable food and beverage packages to suit all of your individual needs. Our dedicated and experienced food and beverage team will create the atmosphere to make your event extra special. [Enquire now](#)



CONTRACTOR SERVICES

ANTIFOULING

The Antifoul Doctor

- Antifoul top side painting
- Top side painting
- Yacht detailing

Doug Hem | 0418 584 445

BOAT BUILDING (FIBREGLASS)

D. Rushbrook Boatbuilder & Marine Services

- qualified ship Wright
- fibreglass and gelcoat repairs
- wooden boat repairs
- Insurance surveys
- antifouling & polishing detailing
- rigging services
- maintenance and restoration
- custom timber fit outs
- spray painting , varnishing

Dan Rushbrook | 0400 769 195

WILKSIE MARINE

Wilksie Marine provide mast fittings, furlers, booms and wire rigging services in the Melbourne, Port Phillip Bay Area. Please contact Janet Wilks for any inquiries | 0439 704 882 or wilksiemarine@gmail.com

Services Provided:

- Rig Inspections
- Yacht wire rigging replacements and tensioning
- Supply, and install furling systems
- Mast fittings and deck hardware
- Wire Swaging
- Rope Splicing
- Halyards
- Life Lines

ALL-ROUND BOAT BUILDER

Bernie Webber is the one of the longest serving boat builders based in Williamstown with over 52 years of experience. He is the owner of BM and SM Webber Boat Builders and has been part of the Williamstown yacht and motor boat community since 1962. The business specializes in major and minor repairs plus refits to vessels of all sizes up to 120ft which includes pleasure and commercial craft.

(03) 9397 4003 or email: webberbr@bigpond.net.au

BOAT BUILDING (TIMBER)

Richard Blake | 0438 332 465

MAINTENANCE

MARINER ENGINEERING

Expert marine service facility and mobile service
12/2 Burleigh Street, Spotswood
(03) 9399 5888
www.mareng.com.au

POWERCRAFT MARINE

Marine mechanical and repair business
2/58 Tennyson Street, Williamstown
0422 258 867
www.powercraftmarine.com.au

WEST OFFSHORE PRODUCTS

Service provider for life rafts and safety equipment
5/2 Sibthorp Street, Mordialloc
(03) 9587 9636
www.westoffshore.com.au

BOATING CENTRAL

158 Nelson Place, Williamstown
Chanderly - Retail only

DISCOUNT YACHTING

Geelong's newest sailing and marine parts store.
173 West Fyans Street, Newtown
www.discountyachting.com.au

DOYLES SAILS

8 Network Drive, Port Melbourne
(03) 9646 5273

NORTH SAILS

39a Lillee Crescent, Tullamarine
0407 263 538

SCUBA SCRUBBA

Anthony Moore
Hull maintenance
0422 104 314

WILLIAMSTOWN SIGNS

150 Nelson Place Williamstown
Signage and banner service
0404 062 024



VISITOR BERTHING

The Club operates and maintains some 175 wet berthing facilities for Members. Berthing at the Royal Yacht Club of Victoria for visitors is very limited; however, every effort is made to accommodate members from kindred clubs and their guests.

View the [Visitor Berthing Information](#) for further information and fill out the form [here](#) to let us know you're on your way.

FEES

Overnight berthing is free for the first night then \$3.50 per metre per night.

SIGN IN

When you arrive, please sign into our guest book to comply with our licensing laws. We look forward to welcoming you soon.

EASTERN FLOATING PONTOON

The floating pontoon on the Eastern side is meant for short stay, loading and unloading after events, and for those using the Eastern Blue Crane. It is not meant for long stay.

If boats are left there unattended, yard staff will relocate them back to their pens. This is a matter of having respect for other members. Police vessels also use this facility.

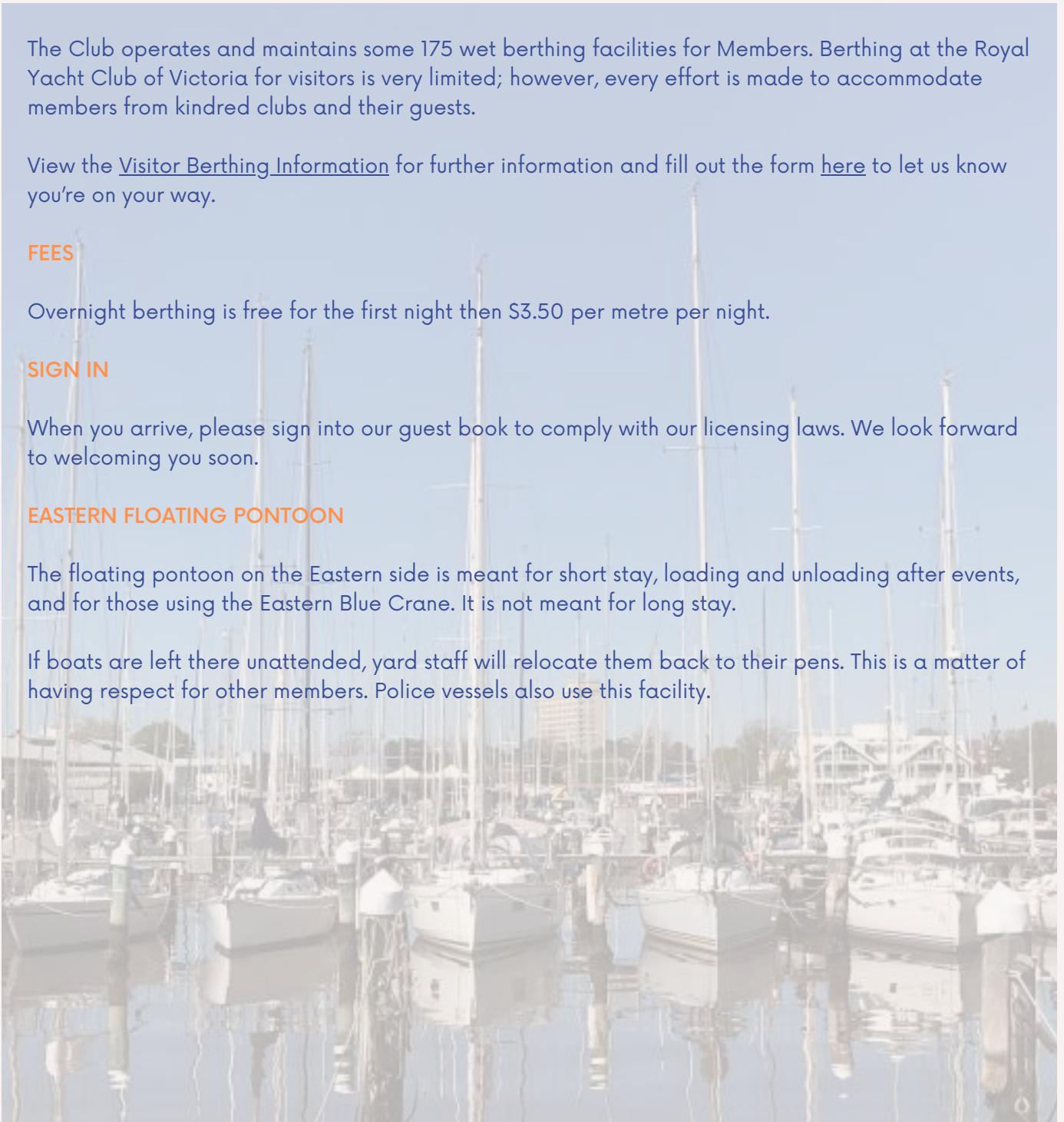

OUR MARINA



SITE MAP

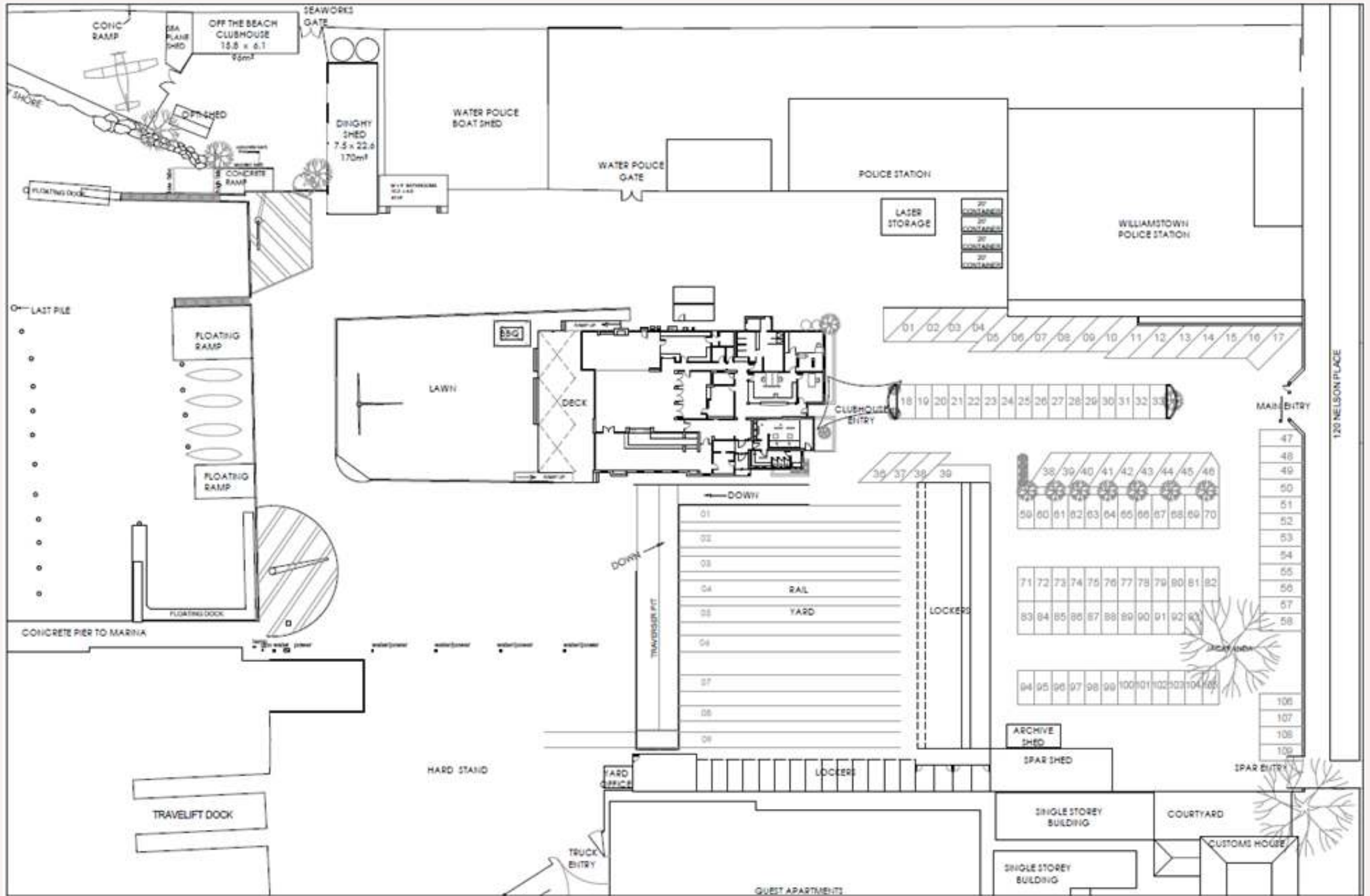

SAILING PROGRAM



SUMMER SATURDAY AGGREGATE SERIES

This series is a selection of 10 Category 6 Saturday races from our sailing calendar.

AUSTRALIAN SAILING RANGE SERIES (PREVIOUSLY NAUTILUS MARINE RANGE SERIES)

The Range Series will be run over three days. The event is managed by several different organisations and offers competitive laid courses at a central location on the Bay. A separate Notice of Race will be issued in due course.

WEDNESDAY TWILIGHT SERIES AND WEDNESDAY AFTERNOON SERIES

The Twilight Series begins in October and runs until March. The Wednesday afternoon series is a pursuit start race which starts from 2pm and runs with and without spinnakers. The Twilight Series offers a multi-division format followed by dinner and a presentation on the deck after racing.

TRIBE & ONIONS/STEAK & MUSHROOMS

This popular series offers social racing on alternative Sunday mornings from October to March. The format is pursuit starts, followed by a very collegial picnic lunch on the deck. A very welcoming group so sign up and get involved.

LIVINGSTON TROPHY

The Livingston Trophy will be awarded to the aggregate winner on AMS of the following long-distance races: The Commodore's Trophy to Portarlington; the Palliser Trophy race to Mornington; the Elwood Huon Trophy; the Festival of the Sails passage race from Melbourne to Geelong; the short version of HBYC Sea Pilot's Race; and the HBYC Don Thompson race to St Leonards.

JEFF GRAY FIXED MARKS SERIES

Honouring the late Jeff Gray, this series includes Lord Brassey Trophy, the Lord Forster Trophy, the Elwood Huon Trophy and Awinya Cup. This series has been designed to meet the needs of our Members seeking longer racing formats with both fixed and laid marks.

VAL HODGE TROPHY

This trophy celebrates Val Hodge, one of our Club's first female skippers, and is part of the Port Phillip Women's Championship Series, open to female skippers and joint female/male crews. The Val Hodge Trophy is held in April.

SAILING PROGRAM



OTB

RYCV Off the Beach sailing offers Members, guests and visiting boats competitive windward leeward racing on Sundays, starting off on Sunday morning with sailing coaching and training for junior sailors. On Sunday afternoons there are two courses for juniors and senior sailors where competitors compete in club aggregates. Classes sailed are: i14, WASZP, Lasers, 29ers, Cadets and Optimists. October.

SAILPASS FOR NON-MEMBERS

Please note: Australian Sailing requires all crew to be members of a Club affiliated with Australian Sailing (that is they will have an AS number) or another World Sailing MNA. If your crew does not have such a qualification, they may acquire a SailPass as detailed on our website [here](#) For Saturday Sailing it is compulsory to lodge a crew list and failure to do so will result in a scoring penalty. By providing a crew declaration, it ensures compliance with our liquor licensing laws, the Racing Rules of Sailing and to provide insurance coverage. We all share this responsibility and need to encourage our non-member crew, who enjoy the privileges of our Club, to sign up for membership and contribute to our running costs.

ANNUAL SAFETY DECLARATION

All boats on the Club's Yacht Register must complete a Safety Declaration each season whether they are sailing or not. All safety and compliance declarations lapse on 30 June each year. The annual safety declaration forms and instructions are available on the Club's sailing webpage under Safety and Registration. Hardcopy forms are also available from the office. When you return the Safety Audit to the Club's office you will be given a sticker to fix to the transom of your boat which must be displayed during racing events. The Sailing Committee will be conducting safety audits prior to racing to demonstrate our commitment to the safety of our Members.

SAILING PROGRAM



MAN OVERBOARD (MOB) DRILL

We sail in an exciting sport, but not without its risk. A well-practiced MOB procedure is critical to minimising the risk of fatalities and conducting MOB drills is an essential part of your annual safety declaration and responsibility as a boat owner. Please ensure that your MOB procedure is designed for your boat and documented so that your crew is familiar with your safety equipment and procedures, and competent in recovery manoeuvres. Regular training is available via the Club's training webpages. If you have any questions, please do not hesitate to contact Ian Fox or Andy Warner who will be able to provide advice and support. Safety comes first.

VHF RADIOS

Please note it is a requirement that boats carry a VHF radio either fixed or handheld, and that a trained VHF radio operator must be on board to operate the radio as required. The Club offers regular VHF Radio Operator training which can be booked via the Club's training webpages. Radio communication is a critical for component of successful recovery operations and is very useful in race management.

CREW

If you are looking for crew, please let Melissa Wisbey or Ian Fox know. We have new Members and graduates of our training programs looking for positions.



ROYALS TRAINING CENTRE



KIDS AND ADULT LEARN TO SAIL

Learn to sail on our keelboats or dinghies
Stand up paddle boards
Windsurfers

DISCOVER SAILING DAY

For anyone who's always wanted to try sailing but never been given the opportunity.

POWERBOAT COURSES

Theory only powerboat licence course
Practical powerboat course
Start powerboating course
Powerboat handling course
Safety boat course

SMALL BOAT COURSES

Start sailing
Better sailing
Start racing
Better racing

KEELBOAT COURSES

Start crewing
Start helming
Keelboat spinnaker
Keelboat seamanship
Start racing

SHORT COURSES

Diesel maintenance
Man-overboard workshop
VHF marine radio course
Club crane course

WWW.RYCV.COM.AU/TRAINING/



HOME OF....



LIPTON CUP REGATTA

LIPTON CUP REGATTA

16 & 17 November 2024

The Regatta for Everyone



WWW.LIPTONCUP.COM.AU

LOCAL INFORMATION



Emergency (Fire, Ambulance, Police) 000

Williamstown Police 9393 9555

Water Police 9399 7500

Coast Guard 9598 9092

Melbourne Ports 9644 9700

Supermarkets

Coles 20 Douglas Parade, Williamstown
Woolworths 71 Kororoit Creek Road, Williamstown

Chandleries

Boating Central 158 Nelson Place, Williamstown 03 9397 6300

Sail Repairs

North Sails 354 Reserve Road, Cheltenham 03 9584 9844
Doyle Sails 8 Network Drive, Port Melbourne 03 9646 5273

Hospitals & Doctors

Williamstown Hospital Railway Crescent, Williamstown 03 9393 0100
Sunshine Hospital 176 Furlong Road, St Albans 03 8345 1333
The Clinic Williamstown 107 Ferguson St, Williamstown 03 9397 1366
The Melbourne Sports Medicine Centre 4/250 Collins St, Melbourne 03 9650 9372

Dentists

Hobsons Bay Dental 72 Electra St, Williamstown 03 9391 5174

Chemists & Pharmacies

Priceline 19-21 Douglas Parade, Williamstown 03 9397 5114

Post Office

Australia Post 70 Douglas Parade, Williamstown 13 13 18

Banks

Commonwealth Bank 46-56 Douglas Parade, Williamstown 03 9397 2177
Bendigo Bank 15 Douglas Parade, Williamstown 03 9399 9266
Westpac 70 Ferguson Street, Williamstown 03 8340 5588
NAB 19-21 Douglas Parade 13 22 65

Taxis & Public Transport

Yellow Cabs 13 22 77
Silver Top Taxi 131 008



ACCOMMODATION & ACTIVITIES

Located just 14 kilometres from Melbourne's CBD by road (8 km as the seagull flies), Royal Yacht Club of Victoria is situated in the heart of Williamstown's historic seaport precinct on Nelson place. There are a number of accommodation options and tourist attractions in surrounding areas, providing something for every budget.

ACCOMMODATION

Aligned Corporate Residences

<https://www.acresidences.com.au/>

Quest North Williamstown

<https://www.questapartments.com.au/properties/vic/williamstown/quest-williamstown-north>

Punthill Apartments

<https://punthill.com.au/hotels/punthill-williamstown/>

Captain's Retreat - Rooms, Apartments & Cottages

<https://captainsretreat.com.au/>

PUBLIC TRANSPORT

Williamstown has 2 railway stations one within a 10 minute walk from the RYCV. On late evenings and weekends, trains will operate between Williamstown and Newport only with a connecting train at Newport. Trains then operate to Flinders Street, operating via the City Loop on weekends. Trains operate between Newport and city approximately every 10 minutes Monday to Friday.

Buses also connect with surround suburbs, major shopping centres and train stations.

Ferries run daily from Gem Pier (next door to the Yacht Club) via the Yarra River which runs through the heart of Melbourne's CBD.



Scan here →

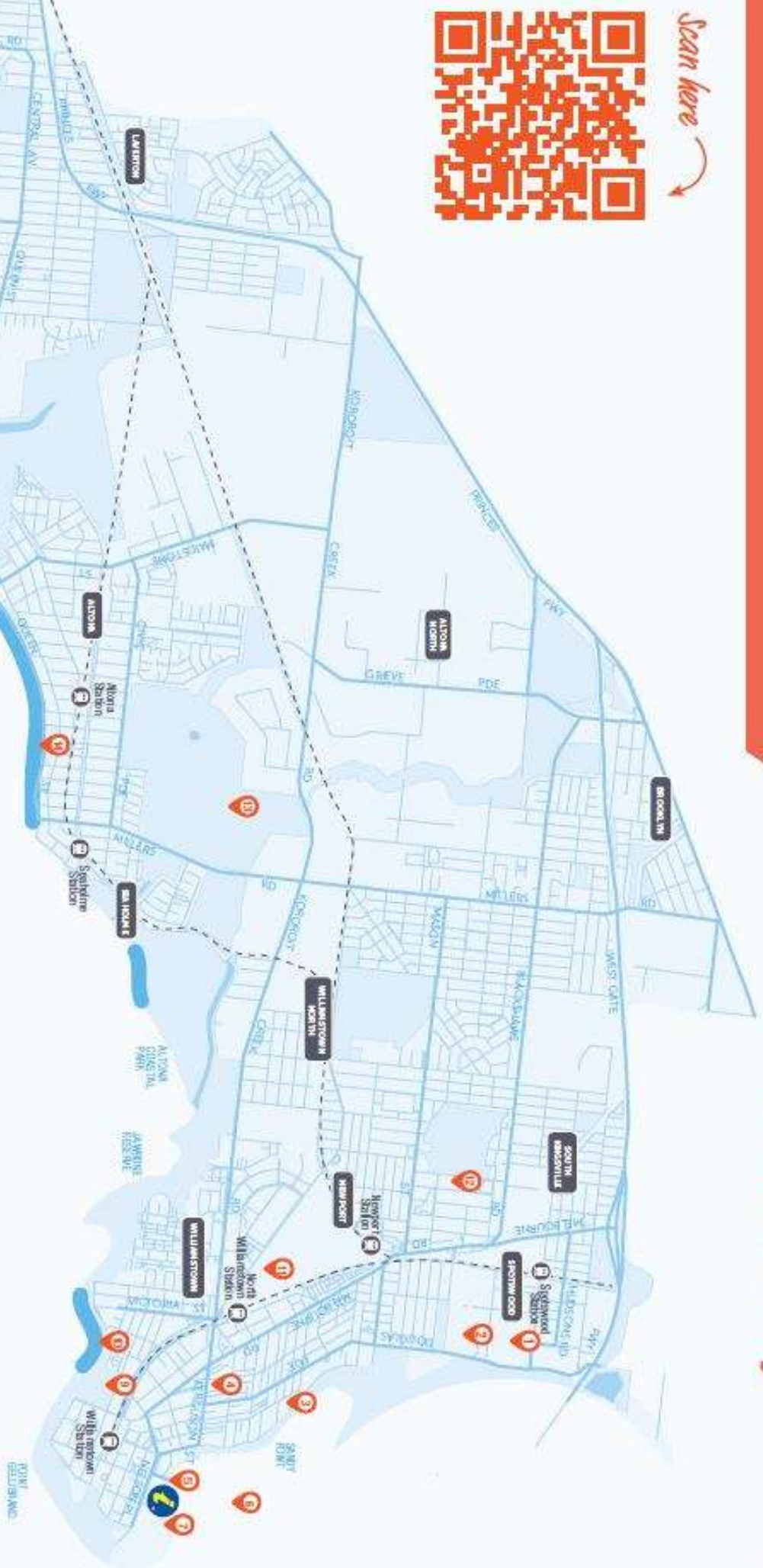

- 1 Grazeland
- 2 Scienceworks
- 3 The Strand
- 4 Williamstown Town Hall
- 5 Gem Pier And Ferry Departure Point To City Or St Kilda
- 6 HMAS Castlemaine Maritime Museum
- 7 Royal Yacht Club of Victoria
- 8 Hobsons Bay Information Centre
- 9 Williamstown Botanic Gardens
- 10 Williamstown Beach
- 11 Newport Railway Museum
- 12 Newport Lakes
- 13 Cherry Lake
- 14 Altona Beach

ACTIVITIES AND ADVENTURES IN HOBSONS BAY

experience
hobsons bay

#experiencehobsonsbay



1. Take your time to explore over 20 kilometres of coastal pathways and enjoy the tranquil setting with cityscape views, beaches and foreshores, and an array of nature to admire.



2. Take a scenic seaplane flight. *



3. Explore Newport lakes, located off Mason Street, Newport. 33 ha of Tranquil bird-rich parklands with walking tracks, lakes, kid's play equipment and BBQ spots.



4. Wander around historic Williamstown waterfront. Discovering some of Melbourne's maritime history from stately homes to quaint seaman's cottages.



5. Visit the Williamstown Botanic Gardens, established in the 1850s.



6. Snorkel at the Jawbone Marine Sanctuary, Williamstown.



7. Work up an appetite and check out the many local eateries across Hobsons Bay.



8. Stand up paddle with Sun Seekers in Altona.



9. Swim at Altona or Williamstown beaches.



9. Rock climb at one of the three indoor climbing centres, Cliff Hanger, Clip and Climb or Climb West.



10. Go on board the HMAS Castlemaine Maritime Museum at Gem Pier, Williamstown. Open weekends and public holidays, with extended days during the Christmas New Year period.*



11. Grab a movie ticket at one of the local cinemas Reading, Altona North or Sun Theatre, Yarraville.



12. Visit the Newport Railway Museum or Altona Miniature Railway.*



13. Walk the 100 steps to federation and take in the views over the Bay and across to the You Yangs. Truganina Coastal Park, Altona Meadows.



14. Take the skateboards and BMX bikes to one of two skate parks.



15. Explore further afield and hop on the West Gate punt to Port Melbourne. Travelling under the famous West Gate Bridge.*

16. Play a game of badminton at the Altona Badminton Centre, 271 Mason Street, Altona North.

17. Check out Seaworks Maritime Museum and Discovery Centre on Nelson Place, Williamstown. Here you can immerse yourself amongst impressive display of artefacts and models that showcase maritime history.*

18. Challenge yourself at Scienceworks in Spotswood, and see the Pumping Station, current exhibition, Melbourne Planetarium, and Lightning Room.

19. Enjoy the feel of village shopping in six diverse locations without the hustle and bustle of the city.

20. Wander through the Truganina Explosives Reserve, Altona on the first Sunday of the month.

21. Swim in the indoor pool at Bay Fit, 257 Mason Street, Altona North.

22. Sail on the Tall Ship Enterprize from Gem Pier*

EVENTS COMING SOON

Christmas Carols. Sunday 18 December, 7pm, Commonwealth Reserve, Williamstown. If inclement weather moves to St Marys Church, 116 Cecil Street, Williamstown.

Caravan Sounds. Saturday 24 December. Caravan Sounds will be spreading Christmas cheer. Carrying fresh beats and holiday themed tunes. Bring a picnic rug and enjoy the music with family and friends. Commonwealth reserve, Williamstown 12 pm till 4pm.

Movies By the Bay. Friday 6 January. Bring a picnic, chairs, rug, popcorn or get something from one of our fabulous local eateries and enjoy free movie, Ticket to Paradise. Commonwealth reserve, Williamstown. Movies shown on dusk.

For more local events visit
What's On - Hobsons Bay



Hobsons Bay Visitor Information Centre *Local people local knowledge*
Corner Syme Street and Nelson Place, Williamstown Ph. 9932 3016
www.experiencehobsonsbay.com

* Operating times vary. For more information visit the Hobsons Bay Visitor Information Centre.

**HOBSONS
BAY CITY
COUNCIL**





CLUB CORE RULES

DRESS CODE

- It is expected that Members and Guests will always be appropriately dressed
- Wet weather gear, sea boots, rubber thongs, bare feet, working clothes & work boots or hats are not permitted in the dining room or Member's bar
- No singlets to be worn inside the Clubhouse
- Sailing gear, mobile phones and caps *are* permitted on the deck
- The dress code may be relaxed from time to time during specific events at the discretion of Club Management/Officer of the Day

BEHAVIOUR CODE

- Parents are responsible for the decorum of their children at all times
- For safety reasons children and others are required to always wear shoes
- It is expected that Members clean the BBQ and surrounding area after use
- Polite etiquette and respectful behaviour always

GENERAL CODE OF CONDUCT

- Dogs are not permitted inside the Clubhouse or on the deck at any time
*(assistance animals are an exemption)
- For the enjoyment of your fellow members & guests, please refrain from using your mobile phone in the dining room & members bar areas (For the purpose of this By-law, "use" means verbal communication only)
- All guests must be signed in by a Member
- NO BYO alcohol

NOTE:

It is the responsibility of Members to ensure that all their guests are made aware of RYCV Dress Code BY-LAWS and assist Club Food & Beverage staff in a courteous manner in the conduct of their duty to enforce the code of conduct when required.

[Read RYCV Rules](#)

[Read RYCV By Laws](#)